



**Technical data**

**2316SKC3**

Double-row self-aligning ball bearings

Self-aligning ball bearing with ball protrusion, pressed steel cage, tapered bore, open

**VISUAL (S)**

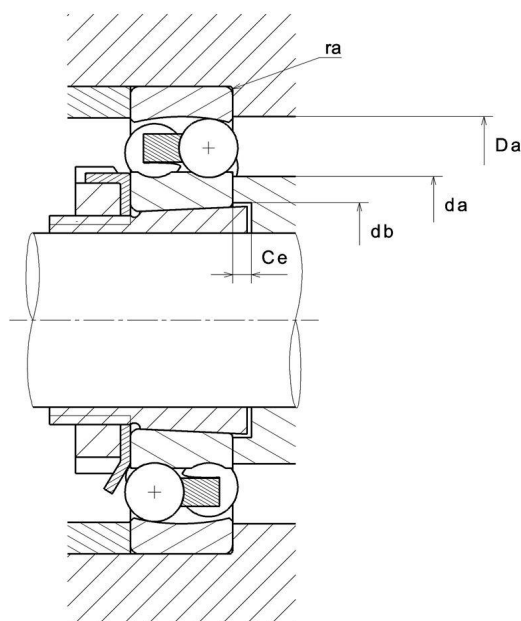
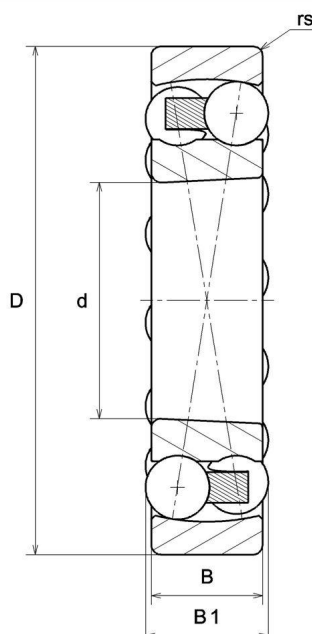

# 2316SKC3

Double-row self-aligning ball bearings

## PRODUCT DIMENSIONS

<b>Internal diameter (d)</b>	80 mm
<b>External diameter (D)</b>	170 mm
<b>Bearing/Inner ring width (B)</b>	58 mm
<b>B1</b>	59 mm
<b>Min fillet radius (rs)</b>	2,1 mm
<b>Associated sleeve reference</b>	H2316X
<b>Coef (e)</b>	0.39
<b>Lower axial load coef (Y1)</b>	1.6
<b>Upper axial load coef (Y2)</b>	2.5
<b>Static axial load coef (Y0)</b>	1.7
<b>Radial clearance class</b>	C3
<b>Precision class</b>	P0
<b>Mass</b>	5,63 kg
<b>Brand</b>	NTN

## PRODUCT PERFORMANCE

<b>Dynamic load (C)</b>	130 kN
<b>Static load (C0)</b>	45 kN
<b>Fatigue limit load (Cu)</b>	1,9 kN
<b>Nlim (oil)</b>	4000 tr/min
<b>Nlim (grease)</b>	3200 tr/min
<b>Min operating temperature (Tmin)</b>	-20 °C
<b>Max operating temperature (Tmax)</b>	120 °C

# 2316SKC3

Double-row self-aligning ball bearings

ABUTMENT	
Min shoulder diameter IR (da min)	91 mm
Max shoulder diameter IR (da max)	103 mm
Min diameter for Sleeve (db)	87 mm
Min length fro Sleeve (Ce)	5 mm
Max shoulder diameter OR (Da max)	159 mm
Max shaft & housing fillet radius (ra max)	2 mm