

FAG

**B7211-E-T-P4S-UL**

## Spindle bearing

Schaeffler ID:  
0191566770000Spindle bearings B72...-E, adjusted, in pairs or sets, contact angle  $\alpha = 25^\circ$ , restricted tolerances

## Technical information

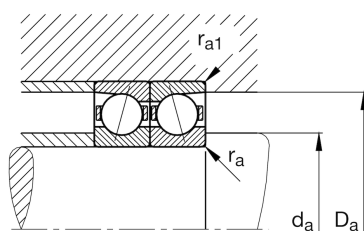
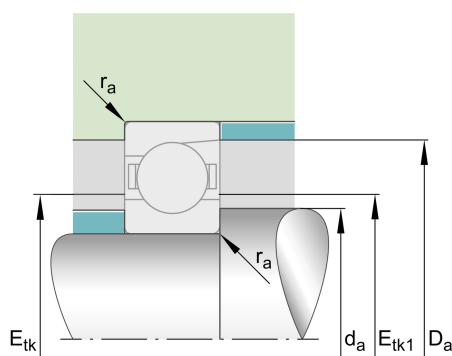
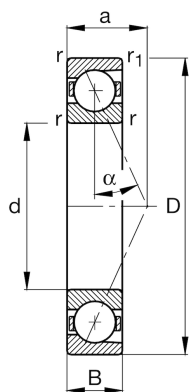
**Main Dimensions & Performance Data**

d	55 mm	Bore diameter
D	100 mm	Outside diameter
B	21 mm	Width
$C_r$	45.000 N	Basic dynamic load rating, radial
$C_{0r}$	25.000 N	Basic static load rating, radial
$C_{ur}$	2.650 N	Fatigue load limit, radial
$n_{G \text{ Grease}}$	13.000 1/min	Limiting speed for grease lubrication
$n_{G \text{ Oil}}$	20.000 1/min	Limiting speed for oil lubrication
	0,612 kg	Weight

**Dimensions**

$r_{\min}$	1,5 mm	Minimum chamfer dimension
$r_{1 \min}$	1,5 mm	Minimum chamfer dimension
$\alpha$	$25^\circ$	Contact angle

**Mounting dimensions**

$d_a$	63 mm	Diameter shaft shoulder
$d_a$	h12	Diameter shaft shoulder clearance
$D_a$	92 mm	Shoulder diameter outer ring
$D_a$	H12	Shoulder diameter outer ring clearance
$r_{a \max}$	1,5 mm	Maximum recess radius
$r_{a1 \max}$	0,6 mm	Maximum recess radius
$E_{tk \min}$	69,9 mm	Minimum diameter injection pitch
$E_{tk \max}$	74,3 mm	Maximum diameter injection pitch
$E_{tk1 \min}$	69,9 mm	Minimum diameter injection pitch
$E_{tk1 \max}$	74,3 mm	Maximum diameter injection pitch
a	28,6 mm	Distance between the apexes of the pressure cones

**Additional information**

$F_{VL}$	378 N	Preload force light
$F_{VM}$	1.321 N	Preload force medium
$F_{VH}$	2.767 N	Preload force heavy
$K_{aEL}$	1.103 N	Lift-off force light
$K_{aEM}$	3.991 N	Lift-off force medium
$K_{aEH}$	8.652 N	Lift-off force heavy
$c_{aL}$	155 N/ $\mu\text{m}$	Axial rigidity light
$c_{aM}$	249 N/ $\mu\text{m}$	Axial rigidity medium
$c_{aH}$	339 N/ $\mu\text{m}$	Axial rigidity heavy