

FAG

**B7205-E-T-P4S-UL**

Spindle bearing

Schaeffler ID:  
0191560490000Spindle bearings B72...-E, adjusted, in pairs or sets, contact angle  $\alpha = 25^\circ$ , restricted tolerances

## Technical information

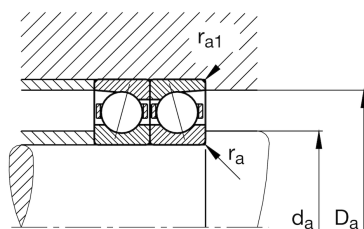
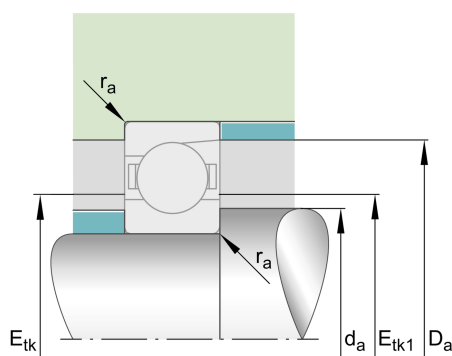
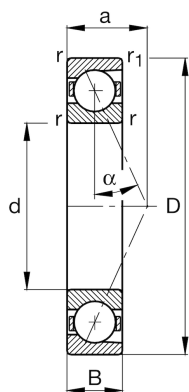
**Main Dimensions & Performance Data**

|                        |              |                                       |
|------------------------|--------------|---------------------------------------|
| d                      | 25 mm        | Bore diameter                         |
| D                      | 52 mm        | Outside diameter                      |
| B                      | 15 mm        | Width                                 |
| $C_r$                  | 14.200 N     | Basic dynamic load rating, radial     |
| $C_{0r}$               | 5.800 N      | Basic static load rating, radial      |
| $C_{ur}$               | 620 N        | Fatigue load limit, radial            |
| $n_{G \text{ Grease}}$ | 26.000 1/min | Limiting speed for grease lubrication |
| $n_{G \text{ Oil}}$    | 40.000 1/min | Limiting speed for oil lubrication    |
|                        | 0,132 kg     | Weight                                |

**Dimensions**

|              |            |                           |
|--------------|------------|---------------------------|
| $r_{\min}$   | 1 mm       | Minimum chamfer dimension |
| $r_{1 \min}$ | 1 mm       | Minimum chamfer dimension |
| $\alpha$     | $25^\circ$ | Contact angle             |

**Mounting dimensions**

|                |         |   |
|----------------|---------|---|
| $d_a$          | 31,5 mm | Diameter shaft shoulder                           |
| $d_a$          | h12     | Diameter shaft shoulder clearance                 |
| $D_a$          | 45,5 mm | Shoulder diameter outer ring                      |
| $D_a$          | H12     | Shoulder diameter outer ring clearance            |
| $r_{a \max}$   | 1 mm    | Maximum recess radius                             |
| $r_{a1 \max}$  | 0,3 mm  | Maximum recess radius                             |
| $E_{tk \min}$  | 34,4 mm | Minimum diameter injection pitch                  |
| $E_{tk \max}$  | 36,5 mm | Maximum diameter injection pitch                  |
| $E_{tk1 \min}$ | 34,4 mm | Minimum diameter injection pitch                  |
| $E_{tk1 \max}$ | 36,5 mm | Maximum diameter injection pitch                  |
| a              | 16,5 mm | Distance between the apexes of the pressure cones |

**Additional information**

|           |                       |                       |
|-----------|-----------------------|-----------------------|
| $F_{VL}$  | 116 N                 | Preload force light   |
| $F_{VM}$  | 429 N                 | Preload force medium  |
| $F_{VH}$  | 914 N                 | Preload force heavy   |
| $K_{aEL}$ | 333 N                 | Lift-off force light  |
| $K_{aEM}$ | 1.293 N               | Lift-off force medium |
| $K_{aEH}$ | 2.868 N               | Lift-off force heavy  |
| $c_{aL}$  | 69,2 N/ $\mu\text{m}$ | Axial rigidity light  |
| $c_{aM}$  | 115 N/ $\mu\text{m}$  | Axial rigidity medium |
| $c_{aH}$  | 159 N/ $\mu\text{m}$  | Axial rigidity heavy  |