

FAG

**B7007-E-T-P4S-UL**

Spindle bearing

Schaeffler ID:  
0190035360000Spindle bearings B70...-E, adjusted, in pairs or sets, contact angle  $\alpha = 25^\circ$ , restricted tolerances

## Technical information

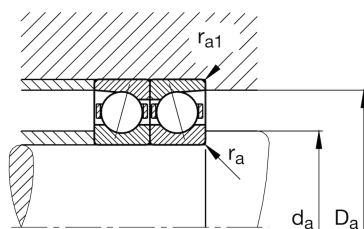
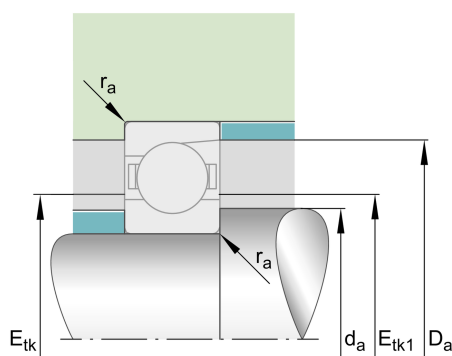
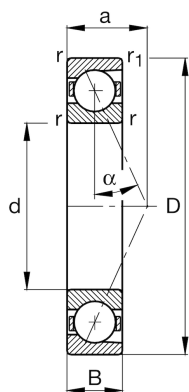
**Main Dimensions & Performance Data**

d	35 mm	Bore diameter
D	62 mm	Outside diameter
B	14 mm	Width
$C_r$	18.400 N	Basic dynamic load rating, radial
$C_{0r}$	9.200 N	Basic static load rating, radial
$C_{ur}$	970 N	Fatigue load limit, radial
$n_{G \text{ Grease}}$	22.000 1/min	Limiting speed for grease lubrication
$n_{G \text{ Oil}}$	34.000 1/min	Limiting speed for oil lubrication
	0,153 kg	Weight

**Dimensions**

$r_{\min}$	1 mm	Minimum chamfer dimension
$r_{1 \min}$	1 mm	Minimum chamfer dimension
$\alpha$	$25^\circ$	Contact angle

**Mounting dimensions**

$d_a$	41 mm	Diameter shaft shoulder
$d_a$	h12	Diameter shaft shoulder clearance
$D_a$	56 mm	Shoulder diameter outer ring
$D_a$	H12	Shoulder diameter outer ring clearance
$r_{a \max}$	1 mm	Maximum recess radius
$r_{a1 \max}$	0,3 mm	Maximum recess radius
$E_{tk \min}$	44,5 mm	Minimum diameter injection pitch
$E_{tk \max}$	46,3 mm	Maximum diameter injection pitch
$E_{tk1 \min}$	44,5 mm	Minimum diameter injection pitch
$E_{tk1 \max}$	46,3 mm	Maximum diameter injection pitch
a	18,3 mm	Distance between the apexes of the pressure cones

**Additional information**

$F_{VL}$	134 N	Preload force light
$F_{VM}$	511 N	Preload force medium
$F_{VH}$	1.097 N	Preload force heavy
$K_{aEL}$	394 N	Lift-off force light
$K_{aEM}$	1.551 N	Lift-off force medium
$K_{aEH}$	3.446 N	Lift-off force heavy
$c_{aL}$	87,9 N/ $\mu\text{m}$	Axial rigidity light
$c_{aM}$	146 N/ $\mu\text{m}$	Axial rigidity medium
$c_{aH}$	200 N/ $\mu\text{m}$	Axial rigidity heavy