

FAG

B7002-E-T-P4S-UL

Spindle bearing

Schaeffler ID:
0191498910000Spindle bearings B70...-E, adjusted, in pairs or sets, contact angle $\alpha = 25^\circ$, restricted tolerances

Technical information

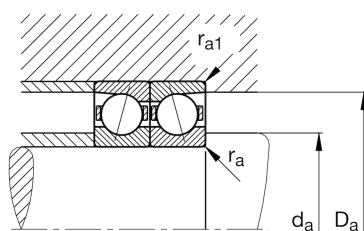
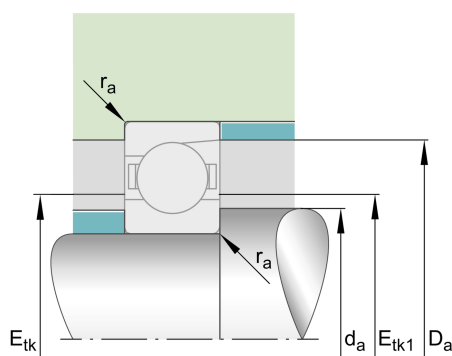
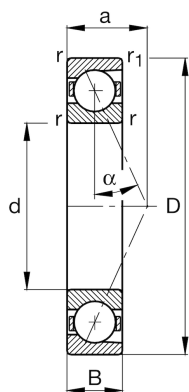
**Main Dimensions & Performance Data**

d	15 mm	Bore diameter
D	32 mm	Outside diameter
B	9 mm	Width
C_r	5.900 N	Basic dynamic load rating, radial
C_{0r}	2.310 N	Basic static load rating, radial
C_{ur}	244 N	Fatigue load limit, radial
$n_{G \text{ Grease}}$	45.000 1/min	Limiting speed for grease lubrication
$n_{G \text{ Oil}}$	70.000 1/min	Limiting speed for oil lubrication
	30 g	Weight

Dimensions

r_{\min}	0,3 mm	Minimum chamfer dimension
$r_{1 \min}$	0,3 mm	Minimum chamfer dimension
α	25°	Contact angle

Mounting dimensions

d_a	19 mm	Diameter shaft shoulder
d_a	h12	Diameter shaft shoulder clearance
D_a	29 mm	Shoulder diameter outer ring
D_a	H12	Shoulder diameter outer ring clearance
$r_{a \max}$	0,3 mm	Maximum recess radius
$r_{a1 \max}$	0,1 mm	Maximum recess radius
$E_{tk \min}$	21,1 mm	Minimum diameter injection pitch
$E_{tk \max}$	22,3 mm	Maximum diameter injection pitch
$E_{tk1 \min}$	21,1 mm	Minimum diameter injection pitch
$E_{tk1 \max}$	22,3 mm	Maximum diameter injection pitch
a	10 mm	Distance between the apexes of the pressure cones

Additional information

F_{VL}	36 N	Preload force light
F_{VM}	154 N	Preload force medium
F_{VH}	341 N	Preload force heavy
K_{aEL}	104 N	Lift-off force light
K_{aEM}	464 N	Lift-off force medium
K_{aEH}	1.066 N	Lift-off force heavy
c_{aL}	37,2 N/ μm	Axial rigidity light
c_{aM}	64,6 N/ μm	Axial rigidity medium
c_{aH}	89,8 N/ μm	Axial rigidity heavy