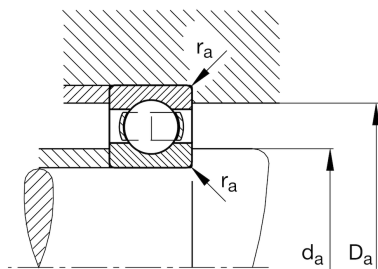
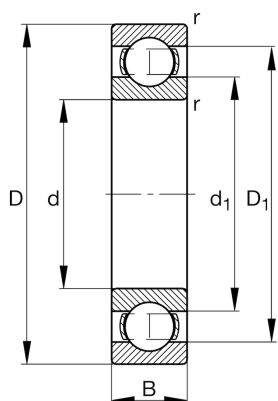

**FAG****6318-C3**

Deep groove ball bearing

Schaeffler ID:  
0167242910030Deep groove ball bearing 63, single row,  
steel sheet metal cage

## Technical information

**Main Dimensions & Performance Data**

d	90 mm	Bore diameter
D	190 mm	Outside diameter
B	43 mm	Width
$C_r$	142.000 N	Basic dynamic load rating, radial
$C_{0r}$	102.000 N	Basic static load rating, radial
$C_{ur}$	5.900 N	Fatigue load limit, radial
$n_G$	4.900 1/min	Limiting speed
$n_{gr}$	5.100 1/min	Reference speed
	5,34 kg	{Weight}

**Mounting dimensions**

$d_{a \min}$	104 mm	Minimum diameter shaft shoulder
$D_{a \max}$	176 mm	Maximum diameter of housing shoulder
$r_{a \max}$	2,5 mm	Maximum fillet radius

**Dimensions**

$r_{\min}$	3 mm	Minimum chamfer dimension
$D_1$	157,18 mm	Shoulder diameter outer ring
$d_1$	123,66 mm	Shoulder diameter inner ring

**Temperature range**

$T_{\min}$	-30 °C	Operating temperature min.
$T_{\max}$	150 °C	Operating temperature max.

**Calculation factors**

$f_0$	13,9	Calculation factor
-------	------	--------------------