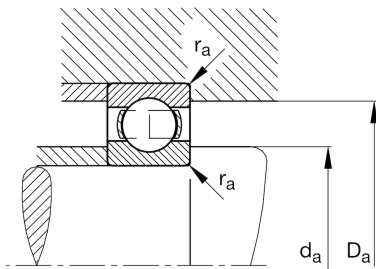
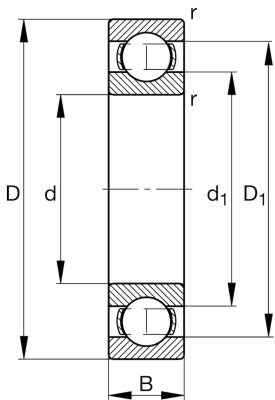

**FAG****6311**

Deep groove ball bearing

Schaeffler ID:
0167237240000Deep groove ball bearing 63, single row,
steel sheet metal cage

Technical information

**Main Dimensions & Performance Data**

d	55 mm	Bore diameter
D	120 mm	Outside diameter
B	29 mm	Width
C_r	83.000 N	Basic dynamic load rating, radial
C_{0r}	47.500 N	Basic static load rating, radial
C_{ur}	3.250 N	Fatigue load limit, radial
n_G	8.500 1/min	Limiting speed
n_{gr}	7.100 1/min	Reference speed
	1,329 kg	{Weight}

Mounting dimensions

$d_{a \min}$	66 mm	Minimum diameter shaft shoulder
$D_{a \max}$	109 mm	Maximum diameter of housing shoulder
$r_{a \max}$	2 mm	Maximum fillet radius

Dimensions

r_{\min}	2 mm	Minimum chamfer dimension
D_1	101,13 mm	Shoulder diameter outer ring
d_1	75,2 mm	Shoulder diameter inner ring

Temperature range

T_{\min}	-30 °C	Operating temperature min.
T_{\max}	150 °C	Operating temperature max.

Calculation factors

f_0	12,9	Calculation factor
-------	------	--------------------