

**FAG**★ **6307-2Z**

Deep groove ball bearing

Schaeffler ID:  
0167232600000Deep groove ball bearing 63...-2Z, single  
row, shields, steel sheet metal cage

★ Preferred product

## Technical information

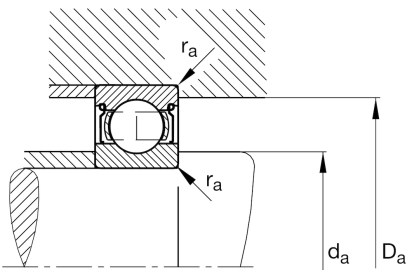
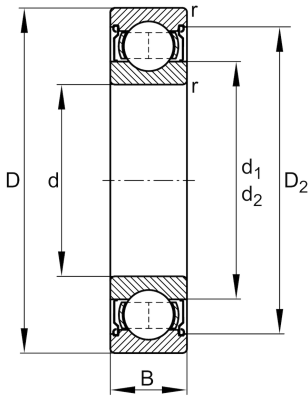
**Main Dimensions & Performance Data**

d	35 mm	Bore diameter
D	80 mm	Outside diameter
B	21 mm	Width
$C_r$	35.500 N	Basic dynamic load rating, radial
$C_{0r}$	19.100 N	Basic static load rating, radial
$C_{ur}$	1.290 N	Fatigue load limit, radial
$n_G$	10.500 1/min	Limiting speed
$n_{gr}$	9.900 1/min	Reference speed
	0,465 kg	Weight

**Dimensions**

$r_{min}$	1,5 mm	Minimum chamfer dimension
$D_2$	67,6 mm	Caliber diameter outer ring
$d_1$	49,3 mm	Shoulder diameter inner ring

**Mounting dimensions**

$d_{a min}$	44 mm	Minimum diameter shaft shoulder
$D_{a max}$	71 mm	Maximum diameter of housing shoulder
$r_{a max}$	1,5 mm	Maximum fillet radius

**Temperature range**

$f_0$	13,1	Calculation factor
$T_{min}$	-20 °C	Operating temperature min.
$T_{max}$	120 °C	Operating temperature max.