

FAG

★ 6307-2RSR

Deep groove ball bearing

Schaeffler ID:
0167232440000Deep groove ball bearing 63...-2RSR,
single row, seals, steel sheet metal cage

★ Preferred product

Technical information

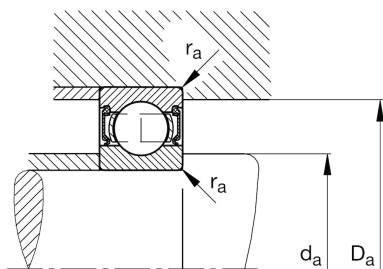
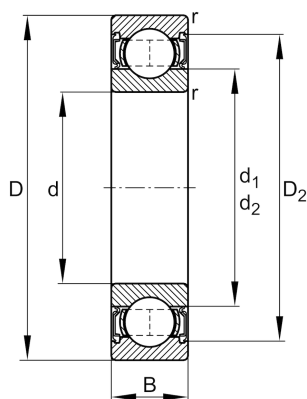

Main Dimensions & Performance Data

d	35 mm	Bore diameter
D	80 mm	Outside diameter
B	21 mm	Width
C_r	35.500 N	Basic dynamic load rating, radial
C_{0r}	19.100 N	Basic static load rating, radial
C_{ur}	1.290 N	Fatigue load limit, radial
n_G	5.400 1/min	Limiting speed
	0,464 kg	Weight

Dimensions

r_{min}	1,5 mm	Minimum chamfer dimension
D_2	67,6 mm	Caliber diameter outer ring
d_1	49,3 mm	Shoulder diameter inner ring

Mounting dimensions

$d_{a min}$	44 mm	Minimum diameter shaft shoulder
$D_{a max}$	71 mm	Maximum diameter of housing shoulder
$r_{a max}$	1,5 mm	Maximum fillet radius

Calculation factors

f_0	13,1	Calculation factor
-------	------	--------------------

Temperature range

T_{min}	-20 °C	Operating temperature min.
T_{max}	110 °C	Operating temperature max.