



FAG

6305-2Z

Deep groove ball bearing

Schaeffler ID:
0167229900000Deep groove ball bearing 63..-2Z, single
row, cf. DIN 625-1

Technical information

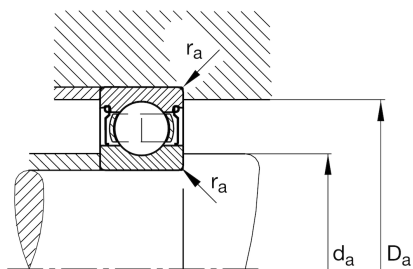
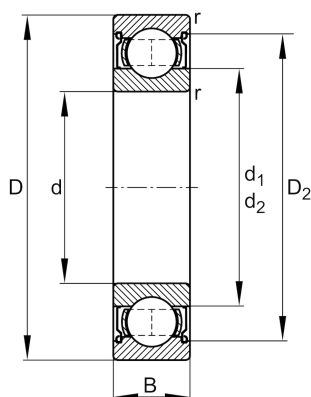
**Main Dimensions & Performance Data**

d	25 mm	Bore diameter
D	62 mm	Outside diameter
B	17 mm	Width
r_{\min}	1,1 mm	Minimum chamfer dimension
C_r	23.800 N	Basic dynamic load rating, radial
C_{0r}	11.500 N	Basic static load rating, radial
C_{ur}	780 N	Fatigue load limit, radial
n_G	13.700 1/min	Limiting speed
n_{gr}	12.300 1/min	Reference speed
	0,24 kg	Weight

Dimensions

D_2	52,5 mm	Caliber diameter outer ring
d_1	36,4 mm	Shoulder diameter inner ring

Mounting dimensions

$d_{a \min}$	32 mm	Minimum diameter shaft shoulder
$D_{a \max}$	55 mm	Maximum diameter of housing shoulder
$r_{a \max}$	1,1 mm	Maximum fillet radius

Temperature range

T_{\min}	-20 °C	Operating temperature min.
T_{\max}	120 °C	Operating temperature max.

Calculation factors

f_0	12,4	Calculation factor
-------	------	--------------------