

FAG

★ 6304-2Z

Deep groove ball bearing

Schaeffler ID:
0167228840000Deep groove ball bearing 63...-2Z, single
row, shields, steel sheet metal cage

★ Preferred product

Technical information

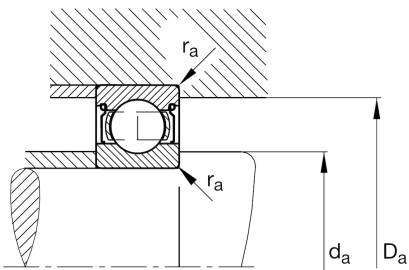
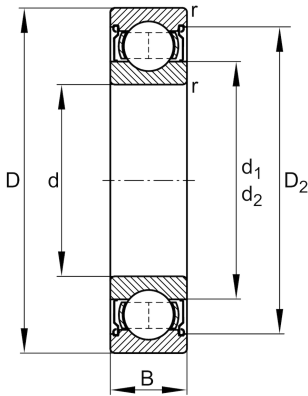

Main Dimensions & Performance Data

d	20 mm	Bore diameter
D	52 mm	Outside diameter
B	15 mm	Width
C_r	16.900 N	Basic dynamic load rating, radial
C_{0r}	7.900 N	Basic static load rating, radial
C_{ur}	540 N	Fatigue load limit, radial
n_G	16.800 1/min	Limiting speed
n_{gr}	14.400 1/min	Reference speed
	0,155 kg	Weight

Dimensions

r_{min}	1,1 mm	Minimum chamfer dimension
D_2	44,4 mm	Caliber diameter outer ring
d_1	30,3 mm	Shoulder diameter inner ring

Mounting dimensions

$d_{a min}$	27 mm	Minimum diameter shaft shoulder
$D_{a max}$	45 mm	Maximum diameter of housing shoulder
$r_{a max}$	1,1 mm	Maximum fillet radius

Calculation factors

f_0	12,4	Calculation factor
-------	------	--------------------

Temperature range

T_{min}	-20 °C	Operating temperature min.
T_{max}	120 °C	Operating temperature max.