

FAG

6301

Deep groove ball bearing

Schaeffler ID:
0167226470000Deep groove ball bearing 63, single row,
steel sheet metal cage

Technical information

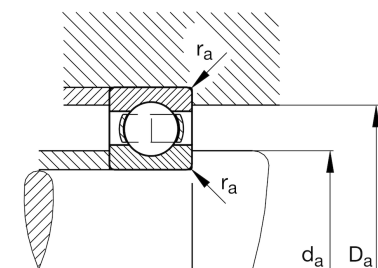
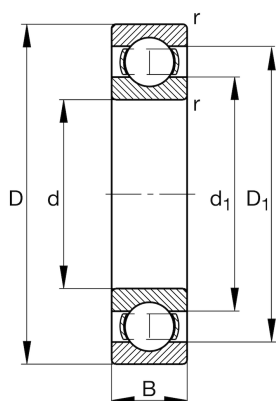
**Main Dimensions & Performance Data**

d	12 mm	Bore diameter
D	37 mm	Outside diameter
B	12 mm	Width
C_r	10.300 N	Basic dynamic load rating, radial
C_{0r}	4.200 N	Basic static load rating, radial
C_{ur}	290 N	Fatigue load limit, radial
n_G	28.500 1/min	Limiting speed
n_{gr}	20.000 1/min	Reference speed
	61 g	Weight

Dimensions

r_{min}	1 mm	Minimum chamfer dimension
D_1	29,6 mm	Shoulder diameter outer ring
d_1	19,5 mm	Shoulder diameter inner ring

Mounting dimensions

$d_{a min}$	17,6 mm	Minimum diameter shaft shoulder
$D_{a max}$	31,4 mm	Maximum diameter of housing shoulder
$r_{a max}$	1 mm	Maximum fillet radius

Calculation factors

f_0	11,1	Calculation factor
-------	------	--------------------

Temperature range

T_{min}	-30 °C	Operating temperature min.
T_{max}	120 °C	Operating temperature max.