



FAG

62307-A-2RSR

Deep groove ball bearing

Schaeffler ID:
0648008650000Deep groove ball bearing 623..-A-2RSR,
single row, steel sheet metal cage

Technical information

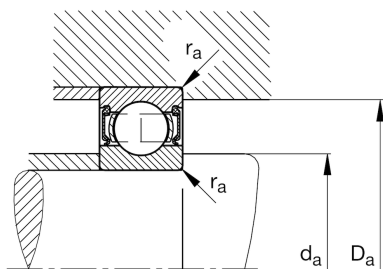
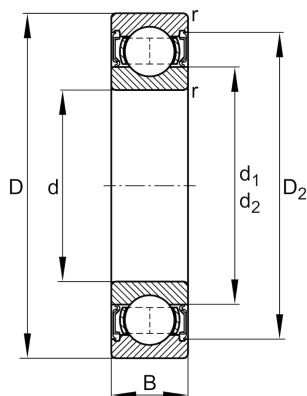
**Main Dimensions & Performance Data**

d	35 mm	Bore diameter
D	80 mm	Outside diameter
B	31 mm	Width
C_r	33.320 N	Basic dynamic load rating, radial
C_{0r}	19.150 N	Basic static load rating, radial
C_{ur}	1.330 N	Fatigue load limit, radial
n_G	5.300 1/min	Limiting speed
	0,65 kg	Weight

Mounting dimensions

$d_{a \min}$	44 mm	Minimum diameter shaft shoulder
$D_{a \max}$	71 mm	Maximum diameter of housing shoulder
$r_{a \max}$	1,5 mm	Maximum fillet radius

Dimensions

r_{\min}	1,5 mm	Minimum chamfer dimension
D_2	70,1 mm	Caliber diameter outer ring
d_1	50,07 mm	Shoulder diameter inner ring

Temperature range

T_{\min}	-20 °C	Operating temperature min.
T_{\max}	100 °C	Operating temperature max.

Calculation factors

f_0	13,1	Calculation factor
-------	------	--------------------