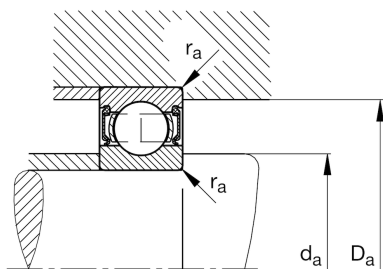
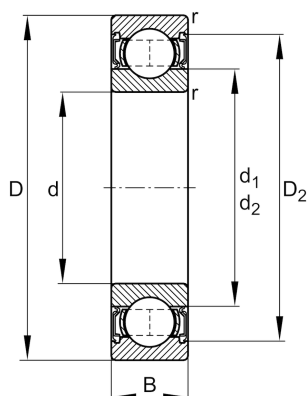

**FAG****62212-2RSR**

Deep groove ball bearing

Schaeffler ID:
0167218700000Deep groove ball bearing 622..-2RSR,
single row, seals, steel sheet metal cage

Technical information

**Main Dimensions & Performance Data**

d	60 mm	Bore diameter
D	110 mm	Outside diameter
B	28 mm	Width
C_r	56.000 N	Basic dynamic load rating, radial
C_{0r}	36.000 N	Basic static load rating, radial
C_{ur}	2.550 N	Fatigue load limit, radial
n_G	3.550 1/min	Limiting speed
	0,998 kg	Weight

Mounting dimensions

$d_{a \min}$	69 mm	Minimum diameter shaft shoulder
$D_{a \max}$	101 mm	Maximum diameter of housing shoulder
$r_{a \max}$	1,5 mm	Maximum fillet radius

Dimensions

r_{\min}	1,5 mm	Minimum chamfer dimension
D_2	97,68 mm	Caliber diameter outer ring
d_1	75,75 mm	Shoulder diameter inner ring

Temperature range

T_{\min}	-20 °C	Operating temperature min.
T_{\max}	100 °C	Operating temperature max.

Calculation factors

f_0	14,3	Calculation factor
-------	------	--------------------