



FAG

62201-A-2RSR

Deep groove ball bearing

Schaeffler ID:
0596145360000Deep groove ball bearing 622..-A-2RSR,
single row, steel sheet metal cage

Technical information

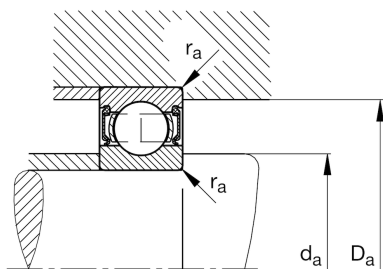
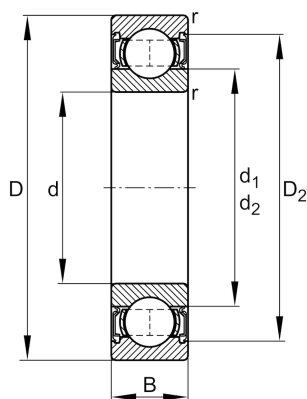
**Dimensions**

r_{\min}	0,6 mm	Minimum chamfer dimension
D_2	27,9 mm	Caliber diameter outer ring
d_1	18,3 mm	Shoulder diameter inner ring
	0,049 kg	Weight

Main Dimensions & Performance Data

d	12 mm	Bore diameter
D	32 mm	Outside diameter
B	14 mm	Width
C_r	6.890 N	Basic dynamic load rating, radial
C_{0r}	3.090 N	Basic static load rating, radial
C_{ur}	243 N	Fatigue load limit, radial
n_G	14.700 1/min	Limiting speed

Mounting dimensions

$d_{a\min}$	16,2 mm	Minimum diameter shaft shoulder
$D_{a\max}$	27,8 mm	Maximum diameter of housing shoulder
$r_{a\max}$	0,6 mm	Maximum fillet radius

Calculation factors

f_0	12,3	Calculation factor
-------	------	--------------------

Temperature range

T_{\min}	-20 °C	Operating temperature min.
T_{\max}	100 °C	Operating temperature max.