

FAG

62200-A-2RSR

Deep groove ball bearing

Schaeffler ID:
0596140050000Deep groove ball bearing 622..-A-2RSR,
single row, steel sheet metal cage

Technical information

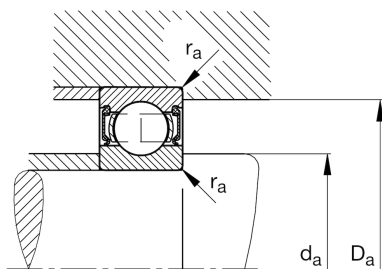
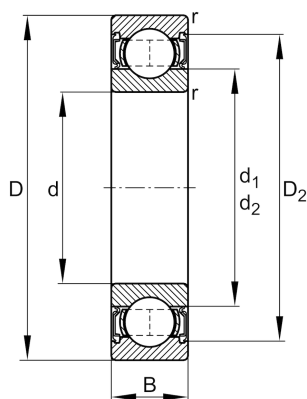
**Main Dimensions & Performance Data**

d	10 mm	Bore diameter
D	30 mm	Outside diameter
B	14 mm	Width
C_r	5.970 N	Basic dynamic load rating, radial
C_{0r}	2.630 N	Basic static load rating, radial
C_{ur}	200 N	Fatigue load limit, radial
n_G	16.700 1/min	Limiting speed
	0,044 kg	Weight

Dimensions

r_{min}	0,6 mm	Minimum chamfer dimension
D_2	25,8 mm	Caliber diameter outer ring
d_1	16 mm	Shoulder diameter inner ring

Mounting dimensions

$d_{a min}$	14,2 mm	Minimum diameter shaft shoulder
$D_{a max}$	25,8 mm	Maximum diameter of housing shoulder
$r_{a max}$	0,6 mm	Maximum fillet radius

Calculation factors

f_0	12,2	Calculation factor
-------	------	--------------------

Temperature range

T_{min}	-20 °C	Operating temperature min.
T_{max}	110 °C	Operating temperature max.