

FAG

## ★ 6217-2Z

Deep groove ball bearing

Schaeffler ID:  
0167214620000

Deep groove ball bearing 62...-2Z, single row, shields, steel sheet metal cage

★ Preferred product

## Technical information

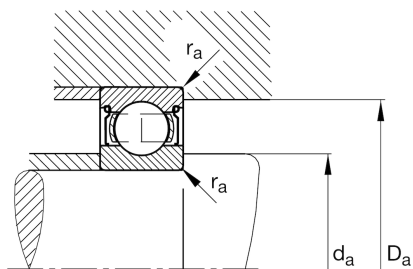
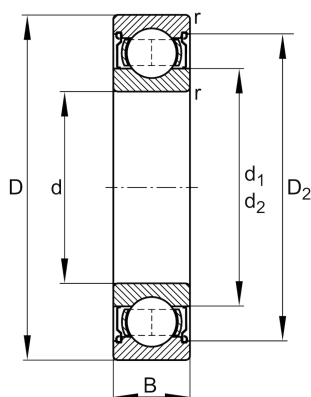

## Main Dimensions &amp; Performance Data

d	85 mm	Bore diameter
D	150 mm	Outside diameter
B	28 mm	Width
C <sub>r</sub>	89.000 N	Basic dynamic load rating, radial
C <sub>0r</sub>	64.000 N	Basic static load rating, radial
C <sub>ur</sub>	4.050 N	Fatigue load limit, radial
n <sub>G</sub>	5.700 1/min	Limiting speed
n <sub>gr</sub>	5.300 1/min	Reference speed
	1,86 kg	Weight

## Dimensions

r <sub>min</sub>	2 mm	Minimum chamfer dimension
D <sub>2</sub>	133,8 mm	Caliber diameter outer ring
d <sub>1</sub>	106,2 mm	Shoulder diameter inner ring

## Mounting dimensions

d <sub>a min</sub>	96 mm	Minimum diameter shaft shoulder
D <sub>a max</sub>	139 mm	Maximum diameter of housing shoulder
r <sub>a max</sub>	2 mm	Maximum fillet radius

## Calculation factors

f <sub>0</sub>	14,8	Calculation factor
----------------	------	--------------------

## Temperature range

T <sub>min</sub>	-20 °C	Operating temperature min.
T <sub>max</sub>	120 °C	Operating temperature max.