

FAG

★ 6212-2RSR

Deep groove ball bearing

Schaeffler ID:
0167209380000Deep groove ball bearing 62...-2RSR,
single row, seals, steel sheet metal cage

★ Preferred product

Technical information

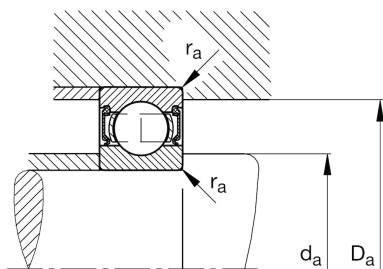
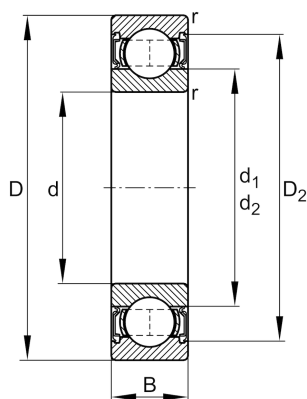

Main Dimensions & Performance Data

d	60 mm	Bore diameter
D	110 mm	Outside diameter
B	22 mm	Width
C_r	57.000 N	Basic dynamic load rating, radial
C_{0r}	36.500 N	Basic static load rating, radial
C_{ur}	2.550 N	Fatigue load limit, radial
n_G	3.550 1/min	Limiting speed
	0,778 kg	Weight

Dimensions

r_{min}	1,5 mm	Minimum chamfer dimension
D_2	97,7 mm	Caliber diameter outer ring
d_1	75,8 mm	Shoulder diameter inner ring

Mounting dimensions

d_{amin}	69 mm	Minimum diameter shaft shoulder
D_{amax}	101 mm	Maximum diameter of housing shoulder
r_{amax}	1,5 mm	Maximum fillet radius

Calculation factors

f_0	14,5	Calculation factor
-------	------	--------------------

Temperature range

T_{min}	-20 °C	Operating temperature min.
T_{max}	110 °C	Operating temperature max.