

FAG

★ 6211-2Z

Deep groove ball bearing

Schaeffler ID:
0167208300000Deep groove ball bearing 62...-2Z, single
row, shields, steel sheet metal cage

★ Preferred product

Technical information

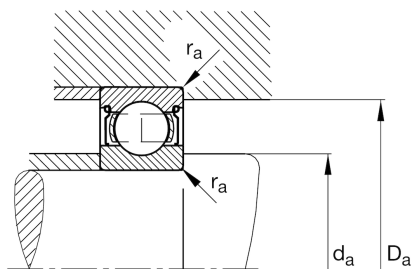
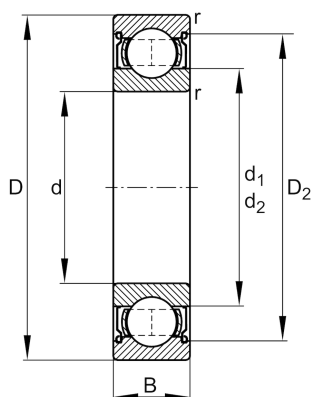

Main Dimensions & Performance Data

d	55 mm	Bore diameter
D	100 mm	Outside diameter
B	21 mm	Width
C_r	46.000 N	Basic dynamic load rating, radial
C_{0r}	29.000 N	Basic static load rating, radial
C_{ur}	1.770 N	Fatigue load limit, radial
n_G	8.000 1/min	Limiting speed
n_{gr}	7.500 1/min	Reference speed
	0,616 kg	Weight

Dimensions

r_{min}	1,5 mm	Minimum chamfer dimension
D_2	88,2 mm	Caliber diameter outer ring
d_1	68,7 mm	Shoulder diameter inner ring

Mounting dimensions

d_{amin}	64 mm	Minimum diameter shaft shoulder
D_{amax}	91 mm	Maximum diameter of housing shoulder
r_{amax}	1,5 mm	Maximum fillet radius

Calculation factors

f_0	14,2	Calculation factor
-------	------	--------------------

Temperature range

T_{min}	-20 °C	Operating temperature min.
T_{max}	120 °C	Operating temperature max.