



FAG

## ★ 6209-2Z

Deep groove ball bearing

Schaeffler ID:  
0167205630000Deep groove ball bearing 62...-2Z, single  
row, shields, steel sheet metal cage

★ Preferred product

## Technical information

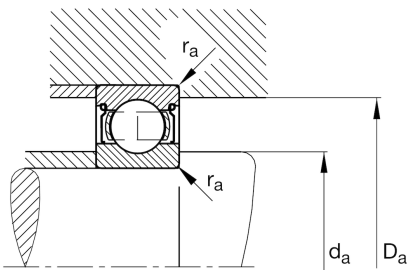
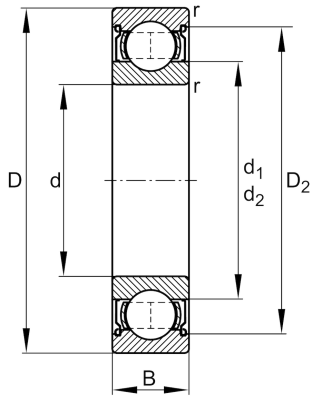

## Temperature range

$T_{\min}$	-20 °C	Operating temperature min.
$T_{\max}$	120 °C	Operating temperature max.
	0,419 kg	Weight

## Main Dimensions &amp; Performance Data

d	45 mm	Bore diameter
D	85 mm	Outside diameter
B	19 mm	Width
$C_r$	33.000 N	Basic dynamic load rating, radial
$C_{0r}$	20.300 N	Basic static load rating, radial
$C_{ur}$	1.400 N	Fatigue load limit, radial
$n_G$	9.800 1/min	Limiting speed
$n_{gr}$	8.900 1/min	Reference speed

## Dimensions

$r_{\min}$	1,1 mm	Minimum chamfer dimension
$D_2$	74,6 mm	Caliber diameter outer ring
$d_1$	57,2 mm	Shoulder diameter inner ring

## Mounting dimensions

$d_{a\min}$	52 mm	Minimum diameter shaft shoulder
$D_{a\max}$	78 mm	Maximum diameter of housing shoulder
$r_{a\max}$	1,1 mm	Maximum fillet radius

## Calculation factors

$f_0$	14,3	Calculation factor
-------	------	--------------------