

FAG

**6209-2RSR**

Deep groove ball bearing

Schaeffler ID:  
0167205390000Deep groove ball bearing 62...-2RSR,  
single row, seals, steel sheet metal cage

## Technical information

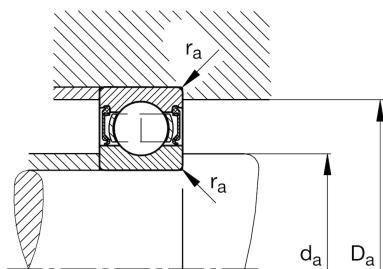
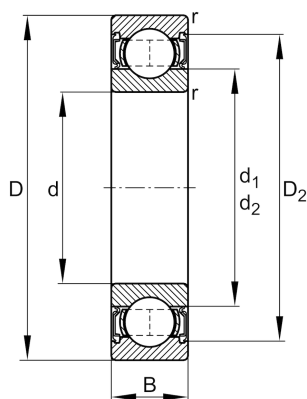
**Main Dimensions & Performance Data**

d	45 mm	Bore diameter
D	85 mm	Outside diameter
B	19 mm	Width
$C_r$	33.000 N	Basic dynamic load rating, radial
$C_{0r}$	20.300 N	Basic static load rating, radial
$C_{ur}$	1.400 N	Fatigue load limit, radial
$n_G$	4.650 1/min	Limiting speed
	0,42 kg	Weight

**Dimensions**

$r_{min}$	1,1 mm	Minimum chamfer dimension
$D_2$	74,6 mm	Caliber diameter outer ring
$d_1$	57,2 mm	Shoulder diameter inner ring

**Mounting dimensions**

$d_{a min}$	52 mm	Minimum diameter shaft shoulder
$D_{a max}$	78 mm	Maximum diameter of housing shoulder
$r_{a max}$	1,1 mm	Maximum fillet radius

**Calculation factors**

$f_0$	14,3	Calculation factor
-------	------	--------------------

**Temperature range**

$T_{min}$	-20 °C	Operating temperature min.
$T_{max}$	110 °C	Operating temperature max.