

**FAG**★ **6205-2Z**

Deep groove ball bearing

Schaeffler ID:  
0167198670000Deep groove ball bearing 62...-2Z, single  
row, shields, steel sheet metal cage

★ Preferred product

## Technical information

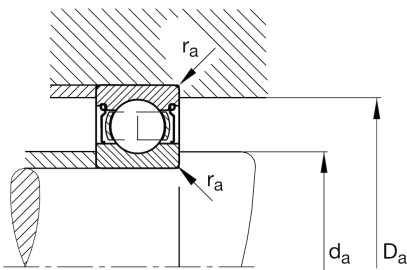
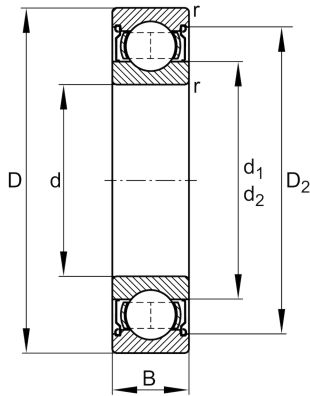
**Temperature range**

$T_{\min}$	-20 °C	Operating temperature min.
$T_{\max}$	120 °C	Operating temperature max.
	0,001 kg	Weight

**Main Dimensions & Performance Data**

d	25 mm	Bore diameter
D	52 mm	Outside diameter
B	15 mm	Width
$C_r$	14.900 N	Basic dynamic load rating, radial
$C_{0r}$	7.800 N	Basic static load rating, radial
$C_{ur}$	530 N	Fatigue load limit, radial
$n_G$	16.700 1/min	Limiting speed
$n_{gr}$	14.400 1/min	Reference speed

**Dimensions**

$r_{\min}$	1 mm	Minimum chamfer dimension
$D_2$	45,4 mm	Caliber diameter outer ring
$d_1$	33,5 mm	Shoulder diameter inner ring

**Mounting dimensions**

$d_{a\min}$	30,6 mm	Minimum diameter shaft shoulder
$D_{a\max}$	46,4 mm	Maximum diameter of housing shoulder
$r_{a\max}$	1 mm	Maximum fillet radius

**Calculation factors**

$f_0$	13,8	Calculation factor
-------	------	--------------------