

FAG

## ★ 61903-2Z

Deep groove ball bearing

Schaeffler ID:  
0554612040000

Deep groove ball bearing 619...-2Z, single row, shields, steel sheet metal cage

★ Preferred product

## Technical information

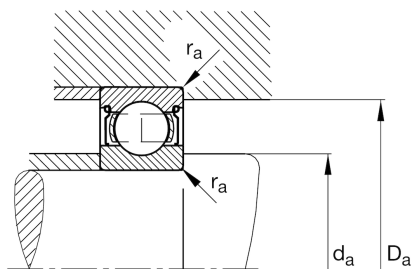
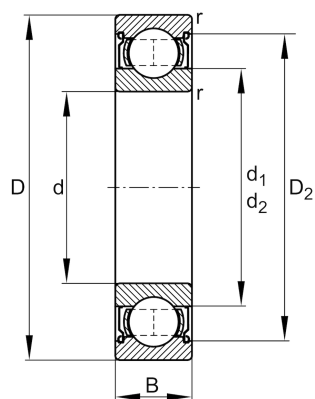

## Main Dimensions &amp; Performance Data

d	17 mm	Bore diameter
D	30 mm	Outside diameter
B	7 mm	Width
$C_r$	4.590 N	Basic dynamic load rating, radial
$C_{0r}$	2.560 N	Basic static load rating, radial
$C_{ur}$	150 N	Fatigue load limit, radial
$n_G$	29.000 1/min	Limiting speed
$n_{gr}$	17.800 1/min	Reference speed
	18 g	Weight

## Dimensions

$r_{min}$	0,3 mm	Minimum chamfer dimension
$D_2$	27,8 mm	Caliber diameter outer ring
$d_1$	21 mm	Shoulder diameter inner ring

## Mounting dimensions

$d_{amin}$	19 mm	Minimum diameter shaft shoulder
$D_{amax}$	28 mm	Maximum diameter of housing shoulder
$r_{amax}$	0,3 mm	Maximum fillet radius

## Calculation factors

$f_0$	14,8	Calculation factor
-------	------	--------------------

## Temperature range

$T_{min}$	-30 °C	Operating temperature min.
$T_{max}$	120 °C	Operating temperature max.