**FAG**★ **608-2Z**

Deep groove ball bearing

Schaeffler ID:
0383906630000

Deep groove ball bearing 60...-2Z, single row, shields, steel sheet metal cage

★ Preferred product

Technical information

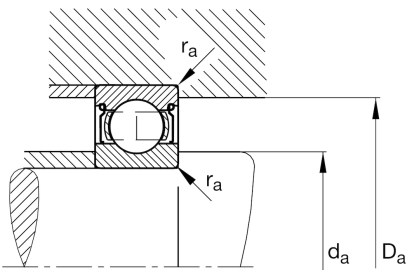
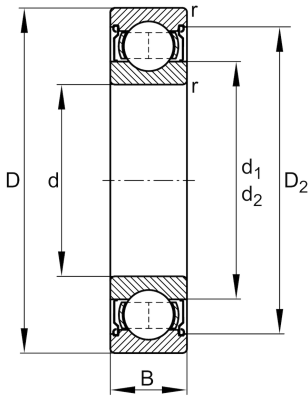
**Temperature range**

T_{\min}	-30 °C	Operating temperature min.
T_{\max}	120 °C	Operating temperature max.
	12 g	Weight

Main Dimensions & Performance Data

d	8 mm	Bore diameter
D	22 mm	Outside diameter
B	7 mm	Width
C_r	3.297 N	Basic dynamic load rating, radial
C_{0r}	1.368 N	Basic static load rating, radial
C_{ur}	74 N	Fatigue load limit, radial
n_G	40.000 1/min	Limiting speed
n_{gr}	31.500 1/min	Reference speed

Dimensions

r_{\min}	0,3 mm	Minimum chamfer dimension
D_2	19,03 mm	Caliber diameter outer ring
d_2	10,5 mm	Caliber diameter inner ring

Mounting dimensions

$d_{a\min}$	10 mm	Minimum diameter shaft shoulder
$D_{a\max}$	20 mm	Maximum diameter of housing shoulder
$r_{a\max}$	0,3 mm	Maximum fillet radius

Calculation factors

f_0	12,4	Calculation factor
-------	------	--------------------