

**FAG****6028**

Deep groove ball bearing

Schaeffler ID:
0167186150000Deep groove ball bearing 60, single row,
steel sheet metal cage

Technical information

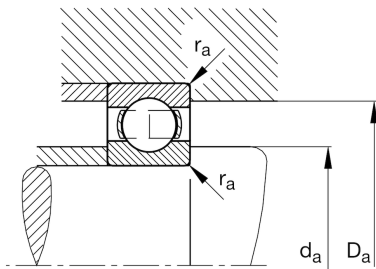
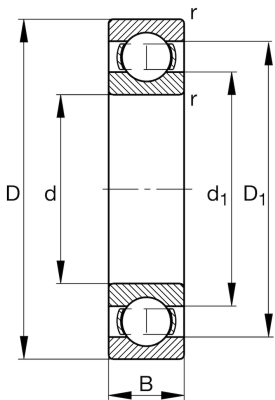

Main Dimensions & Performance Data

d	140 mm	Bore diameter
D	210 mm	Outside diameter
B	33 mm	Width
C_r	117.000 N	Basic dynamic load rating, radial
C_{0r}	109.000 N	Basic static load rating, radial
C_{ur}	5.100 N	Fatigue load limit, radial
n_G	4.250 1/min	Limiting speed
n_{gr}	4.050 1/min	Reference speed
	3,57 kg	{Weight}

Mounting dimensions

$d_{a \min}$	148,8 mm	Minimum diameter shaft shoulder
$D_{a \max}$	201,2 mm	Maximum diameter of housing shoulder
$r_{a \max}$	2 mm	Maximum fillet radius

Dimensions

r_{\min}	2 mm	Minimum chamfer dimension
D_1	187,54 mm	Shoulder diameter outer ring
d_1	162,28 mm	Shoulder diameter inner ring

Temperature range

T_{\min}	-30 °C	Operating temperature min.
T_{\max}	150 °C	Operating temperature max.

Calculation factors

f_0	16	Calculation factor
-------	----	--------------------