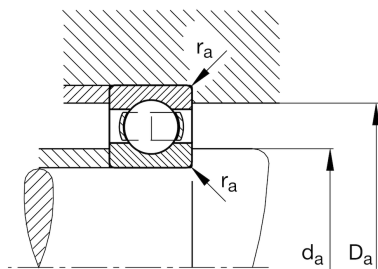
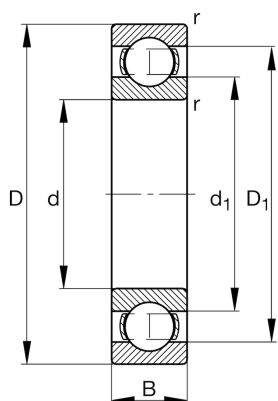

**FAG****6015**

Deep groove ball bearing

Schaeffler ID:
0167180700000Deep groove ball bearing 60, single row,
steel sheet metal cage

Technical information

**Main Dimensions & Performance Data**

| | | |
|----------|-------------|-----------------------------------|
| d | 75 mm | Bore diameter |
| D | 115 mm | Outside diameter |
| B | 20 mm | Width |
| C_r | 42.000 N | Basic dynamic load rating, radial |
| C_{0r} | 33.500 N | Basic static load rating, radial |
| C_{ur} | 2.020 N | Fatigue load limit, radial |
| n_G | 8.100 1/min | Limiting speed |
| n_{gr} | 6.300 1/min | Reference speed |
| | 0,615 kg | {Weight} |

Mounting dimensions

| | | |
|--------------|--------|--------------------------------------|
| $d_{a \min}$ | 81 mm | Minimum diameter shaft shoulder |
| $D_{a \max}$ | 109 mm | Maximum diameter of housing shoulder |
| $r_{a \max}$ | 1 mm | Maximum fillet radius |

Dimensions

| | | |
|------------|-----------|------------------------------|
| r_{\min} | 1,1 mm | Minimum chamfer dimension |
| D_1 | 102,58 mm | Shoulder diameter outer ring |
| d_1 | 88,05 mm | Shoulder diameter inner ring |

Temperature range

| | | |
|------------|--------|----------------------------|
| T_{\min} | -30 °C | Operating temperature min. |
| T_{\max} | 150 °C | Operating temperature max. |

Calculation factors

| | | |
|-------|------|--------------------|
| f_0 | 15,8 | Calculation factor |
|-------|------|--------------------|