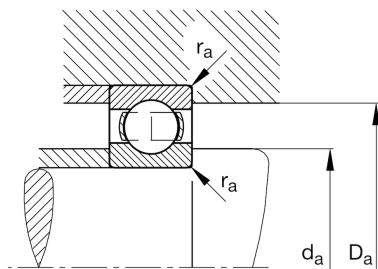
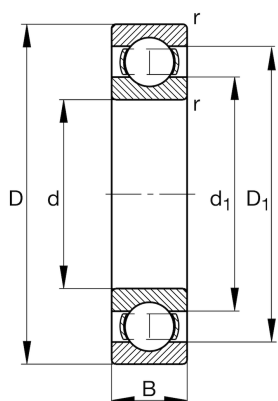

**FAG****6010-C3**

Deep groove ball bearing

Schaeffler ID:  
0167176600030Deep groove ball bearing 60, single row,  
steel sheet metal cage

## Technical information

**Main Dimensions & Performance Data**

d	50 mm	Bore diameter
D	80 mm	Outside diameter
B	16 mm	Width
$C_r$	22.000 N	Basic dynamic load rating, radial
$C_{0r}$	15.800 N	Basic static load rating, radial
$C_{ur}$	800 N	Fatigue load limit, radial
$n_G$	12.200 1/min	Limiting speed
$n_{gr}$	8.900 1/min	Reference speed
	0,258 kg	{Weight}

**Mounting dimensions**

$d_{a \min}$	54,6 mm	Minimum diameter shaft shoulder
$D_{a \max}$	75,4 mm	Maximum diameter of housing shoulder
$r_{a \max}$	1 mm	Maximum fillet radius

**Dimensions**

$r_{\min}$	1 mm	Minimum chamfer dimension
$D_1$	70,2 mm	Shoulder diameter outer ring
$d_1$	59,75 mm	Shoulder diameter inner ring

**Temperature range**

$T_{\min}$	-30 °C	Operating temperature min.
$T_{\max}$	120 °C	Operating temperature max.

**Calculation factors**

$f_0$	15,6	Calculation factor
-------	------	--------------------