

**FAG**★ **6006-2Z**

Deep groove ball bearing

Schaeffler ID:
0167173760000

Deep groove ball bearing 60...-2Z, single row, shields, steel sheet metal cage

★ Preferred product

Technical information

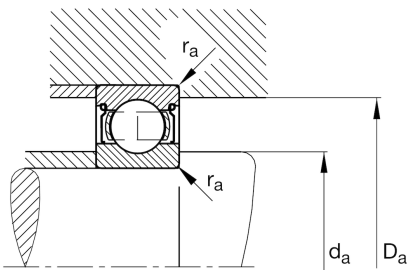
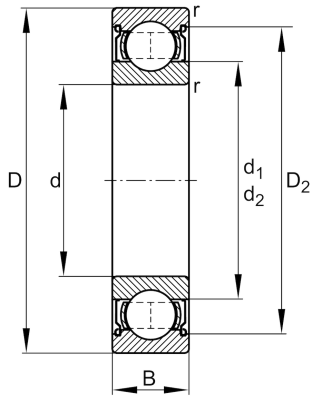
**Main Dimensions & Performance Data**

d	30 mm	Bore diameter
D	55 mm	Outside diameter
B	13 mm	Width
C_r	13.500 N	Basic dynamic load rating, radial
C_{0r}	8.000 N	Basic static load rating, radial
C_{ur}	405 N	Fatigue load limit, radial
n_G	15.700 1/min	Limiting speed
n_{gr}	13.100 1/min	Reference speed
	0,116 kg	Weight

Dimensions

r_{min}	1 mm	Minimum chamfer dimension
D_2	49,2 mm	Caliber diameter outer ring
d_1	38,3 mm	Shoulder diameter inner ring

Mounting dimensions

$d_{a min}$	34,6 mm	Minimum diameter shaft shoulder
$D_{a max}$	50,4 mm	Maximum diameter of housing shoulder
$r_{a max}$	1 mm	Maximum fillet radius

Temperature range

f_0	14,8	Calculation factor
T_{min}	-20 °C	Operating temperature min.
T_{max}	120 °C	Operating temperature max.