



FAG

**51414-MP**

Axial deep groove ball bearing

Schaeffler ID:  
0190631480000Axial deep groove ball bearing 514..-MP,  
single direction, solid brass cage

## Technical information

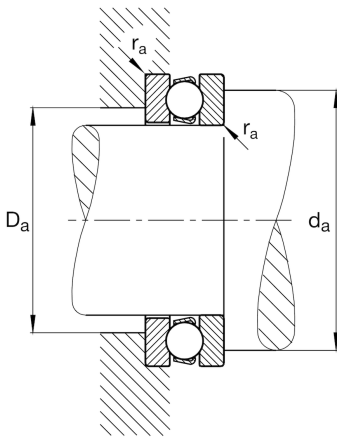
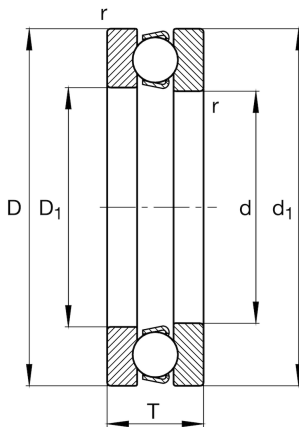
**Main Dimensions & Performance Data**

d	70 mm	Inner diameter shaft washer
D	150 mm	Outer diameter housing washer
T	60 mm	Height
$C_a$	222.000 N	Basic dynamic load rating, axial
$C_{0a}$	500.000 N	Basic static load rating, axial
$C_{ua}$	21.700 N	Fatigue load limit, axial
$n_G$	1.920 1/min	Limiting speed
$n_{gr}$	5.000 1/min	Reference speed
	5,524 kg	Weight

**Mounting dimensions**

$d_{a \min}$	118 mm	Minimum diameter shaft shoulder
$D_{a \max}$	102 mm	Maximum diameter of housing shoulder
$r_{a \max}$	2 mm	Maximum fillet radius

**Dimensions**

$r_{\min}$	2 mm	Minimum chamfer dimension
A	1,4	Minimum load factor
$D_1$	73 mm	Inner diameter housing washer
$d_1$	150 mm	Outer diameter shaft washer

**Temperature range**

$T_{\min}$	-30 °C	Operating temperature min.
$T_{\max}$	150 °C	Operating temperature max.