

FAG

★ 4307-BB-TVH

Deep groove ball bearing

Schaeffler ID:
0219434350000Deep groove ball bearing 43...BB-TVH,
double row, plastic cage

★ Preferred product

Technical information

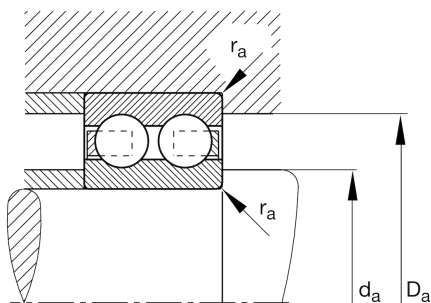
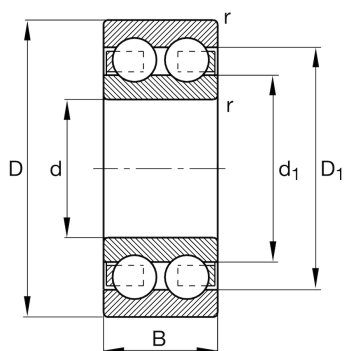

Temperature range

| | | |
|------------|---------|----------------------------|
| T_{\min} | -20 °C | Operating temperature min. |
| T_{\max} | 120 °C | Operating temperature max. |
| | 0,59 kg | Weight |

Main Dimensions & Performance Data

| | | |
|----------|-------------|-----------------------------------|
| d | 35 mm | Bore diameter |
| D | 80 mm | Outside diameter |
| B | 31 mm | Width |
| C_r | 58.000 N | Basic dynamic load rating, radial |
| C_{0r} | 40.500 N | Basic static load rating, radial |
| C_{ur} | 2.120 N | Fatigue load limit, radial |
| n_G | 6.900 1/min | Limiting speed |
| n_{gr} | 6.900 1/min | Reference speed |

Dimensions

| | | |
|------------|---------|------------------------------|
| r_{\min} | 1,5 mm | Minimum chamfer dimension |
| D_1 | 68 mm | Shoulder diameter outer ring |
| d_1 | 48,2 mm | Shoulder diameter inner ring |

Mounting dimensions

| | | |
|--------------|--------|--------------------------------------|
| $d_{a \min}$ | 44 mm | Minimum diameter shaft shoulder |
| $D_{a \max}$ | 71 mm | Maximum diameter of housing shoulder |
| $r_{a \max}$ | 1,5 mm | Maximum fillet radius |

Calculation factors

| | | |
|-------|------|--------------------|
| f_0 | 12,9 | Calculation factor |
|-------|------|--------------------|