

FAG

★ 4305-BB-TVH

Deep groove ball bearing

Schaeffler ID:
0219434190000Deep groove ball bearing 43...BB-TVH,
double row, plastic cage

★ Preferred product

Technical information

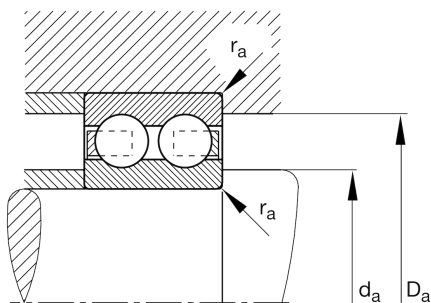
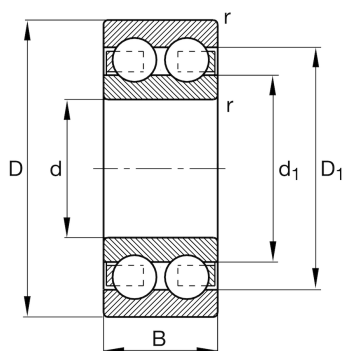

Temperature range

T_{min}	-20 °C	Operating temperature min.
T_{max}	120 °C	Operating temperature max.
	0,342 kg	Weight

Main Dimensions & Performance Data

d	25 mm	Bore diameter
D	62 mm	Outside diameter
B	24 mm	Width
C_r	34.500 N	Basic dynamic load rating, radial
C_{0r}	22.900 N	Basic static load rating, radial
C_{ur}	1.190 N	Fatigue load limit, radial
n_G	9.400 1/min	Limiting speed
n_{gr}	8.500 1/min	Reference speed

Dimensions

r_{min}	1,1 mm	Minimum chamfer dimension
D_1	49,9 mm	Shoulder diameter outer ring
d_1	37 mm	Shoulder diameter inner ring

Mounting dimensions

$d_{a min}$	32 mm	Minimum diameter shaft shoulder
$D_{a max}$	55 mm	Maximum diameter of housing shoulder
$r_{a max}$	1 mm	Maximum fillet radius

Calculation factors

f_0	13	Calculation factor
-------	----	--------------------