



FAG

**2204-2RS-TVH**

Self-aligning ball bearing

Schaeffler ID:  
0167026890000

Self-aligning ball bearing 22..-2RS-TVH

## Technical information

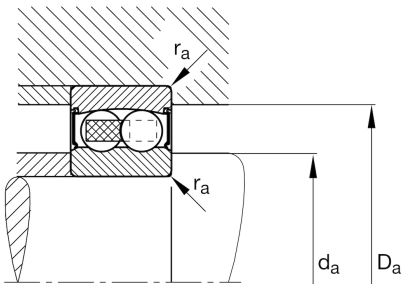
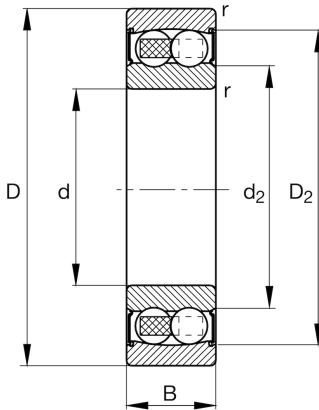
**Main Dimensions & Performance Data**

d	20 mm	Bore diameter
D	47 mm	Outside diameter
B	18 mm	Width
$r_{\min}$	1 mm	Minimum chamfer dimension
$C_r$	10.100 N	Basic dynamic load rating, radial
$C_{0r}$	2.600 N	Basic static load rating, radial
$C_{ur}$	166 N	Fatigue load limit, radial
$n_G$	9.400 1/min	Limiting speed
	0,145 kg	Weight

**Dimensions**

$D_2$	41 mm	Caliber diameter outer ring
$d_2$	25,8 mm	Caliber diameter inner ring

**Mounting dimensions**

$d_{a\min}$	25,6 mm	Minimum diameter shaft shoulder
$d_{a\max}$	25,6 mm	Maximum diameter shaft shoulder
$D_{a\max}$	41,4 mm	Maximum diameter of housing shoulder
$r_{a\max}$	1 mm	Maximum fillet radius

**Temperature range**

$T_{\min}$	-20 °C	Operating temperature min.
$T_{\max}$	100 °C	Operating temperature max.

**Calculation factors**

e	0,28	Limiting value of $F_a/F_r$ for the applicability of diff. Values of factors X and Y
$Y_1$	2,24	Dynamic axial load factor
$Y_2$	3,47	Dynamic axial load factor
$Y_0$	2,35	Static axial load factor