

FAG

20210-TVP

Barrel roller bearing

Schaeffler ID:
0167018010000

Barrel roller bearings 202, main
dimensions to DIN 635-1

Technical information

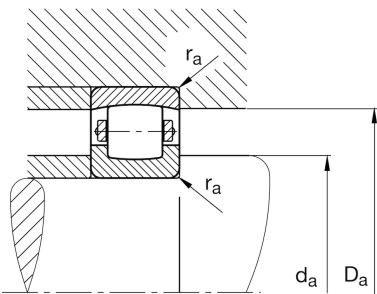
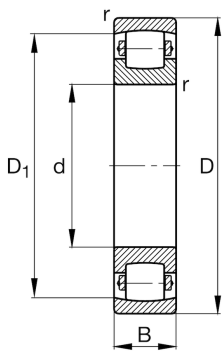

Main Dimensions & Performance Data

d	[50] mm	Bore diameter
D	[90] mm	Outside diameter
B	[20] mm	Width
C _r	[59.000] N	Basic dynamic load rating, radial
C _{0r}	[69.000] N	Basic static load rating, radial
C _{ur}	[7.200] N	Fatigue load limit, radial
n _G	[7.700] 1/min	Limiting speed
	[0,481] kg	Weight

Mounting dimensions

d _{a min}	[57] mm	Minimum diameter shaft shoulder
D _{a max}	[83] mm	Maximum diameter of housing shoulder
r _{a max}	[1] mm	Maximum recess radius

Dimensions

r _{min}	[1,1] mm	Minimum chamfer dimension
D ₁	[79,5] mm	Bore diameter outer ring

Temperature range

T _{min}	[-30] °C	Operating temperature min.
T _{max}	[120] °C	Operating temperature max.