

FAG

**11204-TVH**

Self-aligning ball bearing

Schaeffler ID:  
0167001200000Self-aligning ball bearing 112...TVH, plastic  
cage

## Technical information

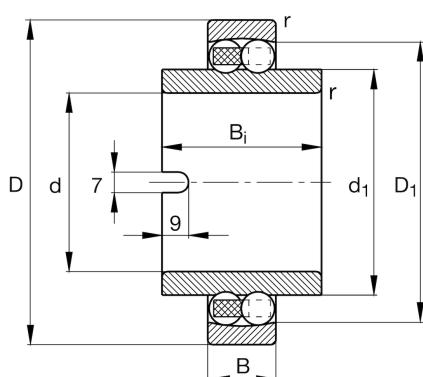
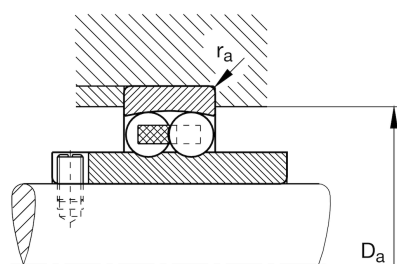
**Main Dimensions & Performance Data**

d	20 mm	Bore diameter
D	47 mm	Outside diameter
B	14 mm	Width, outer ring
B <sub>i</sub>	40 mm	Width, inner ring
r <sub>min</sub>	1 mm	Minimum chamfer dimension
C <sub>r</sub>	10.100 N	Basic dynamic load rating, radial
C <sub>0r</sub>	2.600 N	Basic static load rating, radial
C <sub>ur</sub>	166 N	Fatigue load limit, radial
n <sub>G</sub>	18.100 1/min	Limiting speed
n <sub>gr</sub>	15.300 1/min	Reference speed
	0,186 kg	Weight

**Dimensions**

D <sub>1</sub>	37,8 mm	Shoulder diameter outer ring
D <sub>a max</sub>	41,4 mm	Maximum diameter of housing shoulder
d <sub>1</sub>	29,2 mm	Shoulder diameter inner ring
r <sub>a max</sub>	1 mm	Maximaler Hohlkehlradius
b	7 mm	Width retaining slot
t	9 mm	Hight retaining slot

**Calculation factors**

e	0,28	Limiting value of Fa/Fr for the applicability of diff. Values of factors X and Y
Y <sub>1</sub>	2,24	Dynamic axial load factor
Y <sub>2</sub>	3,47	Dynamic axial load factor
Y <sub>0</sub>	2,35	Static axial load factor